

DECEMBER 2025

2025 Street Party

Friday 12 December - See You There

*Shire of Dalwallinu &
Dalwallinu Lions Club*

pre **CHRISTMAS STREET PARTY**

Friday 12 December from 5:30pm

Johnston Street, Dalwallinu



*Children's
Activities -
Santa*

**Food -
Music - Bar**

Place of wheat and wattle....

CEO Chit Chat



CHIEF EXECUTIVE OFFICER, Jean Knight JP

Don't forget that the Annual Street Party is Friday 12 December 2025.

Council have recently awarded a tender to Modular WA for the construction of an additional two modular 1x1 units to be constructed in the Aged Precinct in McNeill Street. This is Stage 1 of the planned upgrade for this precinct.

We thank the Uniting Church for providing \$100,000 towards this project.

The Shire is currently advertising the Wubin Town Hall and Buntine

Town Hall for sale by tender. The buildings have not been utilised for many years, and the sale provides an opportunity for a third party to purchase.

With the warmer weather on the way, the Dalwallinu Aquatic Centre is coming alive. The Shire's swim school is booked out along with the Infant Classes. This is a fantastic effort as we all know Safety around Water is a vital skill to learn. Aquafit is also bringing a few to the pool even though the weather has not been the warmest.

Unfortunately, we did not receive any nominations for the 2026 Citizen of the Year. We will be hosting a citizenship ceremony at the Australia Day Celebrations at the Dalwallinu Aquatic Centre on Monday 26 January 2026 from 9:00am following the Australia Day breakfast which starts at 8:00am.

We commenced advertising a survey relating to Seniors Housing. Please take the time to complete the survey as this data will help the Council plan for housing projects into the future.

More details about this survey are available in this newsletter and on the website.

I would like to acknowledge the passing of former Councillor Noel Pearse, who passed away last month. Noel was a Councillor from 1974-1980. My deepest sympathy to his family during this time.

Just a reminder to the community to follow the Shire of Dalwallinu Facebook page. We do advertise on our website and in the TL and Kapers, however the easiest way to follow any news from the Shire is to follow our page.

We welcome two new Works crew to the team this month – Dean Draper and Rodney Aldridge.

Please note that the Shire Admin, Shire Depot and Dalwallinu Discovery Centre will be closed from 3:00pm Tuesday 23 December 2025 and will re-open at 8:30am Monday 5 January 2026

On behalf of the Staff at the Shire, we wish everyone a Happy and Safe Christmas and New Year.

VALE



Noel Pearse
Shire Councillor
1974 - 1980

Reminder - Next Rate Instalment Due 31 December 2025



With the excitement of Christmas and holidays sometimes payments get forgotten or overlooked.

Don't let it slip your mind that the next Rates Instalment due date is 31 December 2025.

If you have any queries regarding your rates account, please contact the Shire's rates officer on (08) 9661 0500 or email to rates@dalwallinu.wa.gov.au.

A Word from the Shire President



Cr Keith Carter, SHIRE PRESIDENT

As 2025 draws to a close it is a good time to reflect on the work that has been completed by the Shire over this period. The townships in the Shire are looking fantastic, and this is due to the hard work of the Shire staff.

The work begins well before a machine is started and Jean and her leadership team in Hanna, Marc and Doug are to be congratulated

on building a sustainable budget to continue these works each year.

I would like to also take this opportunity to thank the Councillors who contribute their time towards governing the Shire and working with our CEO and her team to move Dalwallinu forward into the future. The growth in the Shire over the last year has been incredible.

There are only 3 industrial lots still for sale and only 1 residential lot in the new residential estate left to buy. This is a positive for the entire region.

I had the pleasure to join with our staff for a Christmas celebration on Saturday night. This gave Councillors a chance to recognise and thank the staff for their contribution throughout the last year. The administration team, works crew, aquatic centre, cleaners and management all

work together to enable Council to complete all their annual targets. So, thank you to all of the team.

On behalf of Council I would like to wish Cr Jemma Counsel a speedy recovery from her recent surgery. We hope to see her fully recovered soon.

Sadly, we also acknowledge the passing of another former Councillor with the recent loss of Noel Pearse. Our thoughts are with his family.

Please remember we will have increased traffic over the Christmas and New Year period. With a lot of tourists on the roads it is always a good reminder to remain vigilant when driving on our roads.

Finally, on behalf of Council I would like to wish everyone a safe and happy Christmas and we look forward to seeing you all again next year.

Capital Projects 2025 - 2026

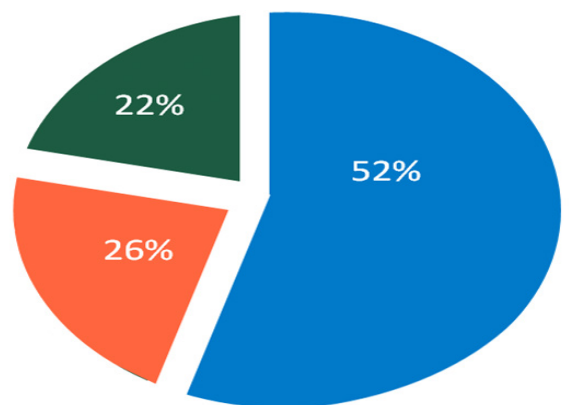
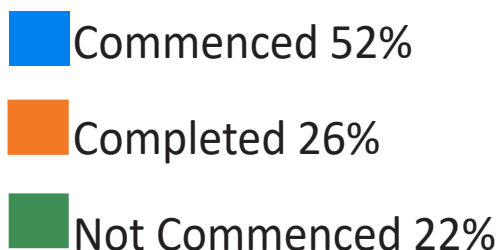

2025-2026 Christmas Closure Dates

The Shire of Dalwallinu will close down for the Christmas period at 3pm on Tuesday 23 December 2025. This includes the Shire Administration Office, Dalwallinu Discovery Centre and Shire Works Depot.

The Shire will re-open for business at 8.30am on Monday 5 January 2026. The staff would like to wish all residents of the Shire a safe and happy Christmas and look forward to serving you again next year.



Place of wheat and wattle....

Australia Day Celebrations



Happy Australia Day



January 2026

Free Breakfast

Citizenship Ceremony

At Dalwallinu
Aquatic Centre

From 8:00am—9.30am
Provided by Shire of Dalwallinu



Place of wheat and wattle....

Aquatic Centre Holiday Opening Hours

CHRISTMAS & NEW YEAR OPENING HOURS

Wed 24 December	Closing at 4:00pm
Christmas Day	CLOSED
Boxing Day	CLOSED
Sat 27 December	CLOSED
Sun 28 December	CLOSED
Mon 29 December	CLOSED
Tue 30 December	Normal Hours
New Years Eve	Normal Hours
New Years Day	CLOSED

Dalwallinu Aquatic Centre
dalwallinuac@gmail.com
9661 1271



Christmas Rubbish Collection Changes



The following arrangements have been made for the collection of services which would normally be done on Wednesday 24 December and Thursday 25 December 2025.

KALANNIE, BUNTINE & WUBIN

The Collection due for general waste in Kalannie, Buntine and Wubin on Wednesday the 24 December 2025 will be serviced on **Tuesday 23 December 2025**.

DALWALLINU

The collection due for both general waste and recycle in Dalwallinu on Thursday 25 December 2025 will be serviced on **Wednesday 24 December 2025**.



Place of wheat and wattle....

Final 2025 Council Meeting Date

DATE	DAY	TIME	PLACE
16 December 2025	Tuesday	5.00pm	Council Chambers

Harvest Ban SMS Service

Please contact Customer Service Officers on 9661 0500 or email sfo@dalwallinu.wa.gov.au if you would like to be removed from this service. If you have new seasonal workers, consider having them added.

To be added contact our Customer Service Officers or email sfo@dalwallinu.wa.gov.au. The following details are required

- First & Last Name
- Employer
- Mobile
- Permanent or 2025/2026 Season List



Dalwallinu Discovery Centre Information

The Library and Discovery Centre
will be closed from
4.30pm - Monday 22 December 2025
and reopen

9am - Monday 5 January 2026

We would like to wish you all a safe
and very Merry Christmas



Place of wheat and wattle....

Dalwallinu Discovery Centre Information

Library News

The holidays are almost here.

We've got great books for the kids, plus a selection of awesome Christmas-dinner inspiration to help you plan the perfect festive feast.

Come in and browse through our shelves to find a book that will interest or enthrall you.

The children can enjoy the relaxing cubby nook for younger readers.

If you have a favourite author and you would like to see if they could be available have a chat to the staff at the DDC.

The library is open from Monday to Friday.

Why don't you call in to find your next read.



Youth Advisory Council

The Youth Advisory Council wrapped up its final meeting of the year with a burst of energy! We welcomed awesome new members and are already buzzing with fresh ideas for next year.

Our Youth Survey is included in this edition and we want YOUR voice to help shape exciting projects and activities.

The survey is also available on our website, facebook page and from the DDC.



Author of the Month - Michael Connelly

A brief Summary of...

Michael Connelly - is an American author of detective novels and other crime fiction.

Connelly is the bestselling author of 38 novels and one work of non-fiction, with over 74 million copies of his books sold worldwide and translated into 40 languages.

After graduating from the University of Florida in 1980, Connelly got a job as a crime beat writer at the Daytona Beach News-Journal, where he worked for almost two years.

Connelly describes his work as a big canvas with all the characters of his books floating across it as currents on a painting. Sometimes they are bound to collide, creating cross currents.

This is something that Connelly creates by bringing back characters from previous books and letting them play a part in books written five or six years after first being introduced.

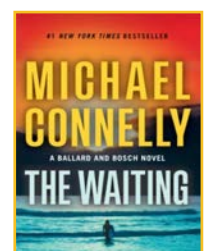
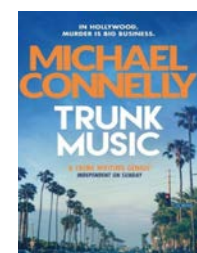
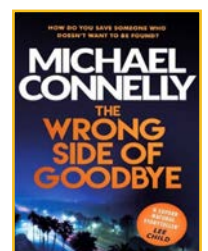
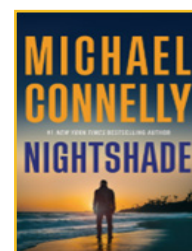

Seniors Housing Survey



Supporting the building of seniors' housing is a priority for the Shire and as a result we are undertaking a survey of seniors' housing options. These include:

- Rental units with no services for independent living
- Rental units with supported living services
- Affordable housing for those on limited income to purchase

The survey is being undertaken to help to identify the types of projects that will be the most appropriate for the seniors of the area. We need to get a sense of needs, preferences, when required and what's important to you. The results of this survey will assist in future budgeting and planning needs.

This is about your future. Thank you for participating.

Copies of the survey are available from:

- Dalwallinu Shire Office
- Dalwallinu Discovery Centre
- Shire website <https://www.dalwallinu.wa.gov.au/news/seniors-housing-survey/1741>

Surveys can be returned to:

- Dalwallinu Shire Office
- Dalwallinu Discovery Centre
- By post to PO Box 141 Dalwallinu WA 6609
- Email to shire@dalwallinu.wa.gov.au

Please return the survey by close of business Friday 20 February 2026.

Tender

RFT2526-05 – REMOVAL & REPLACEMENT OF SYNTHETIC BOWLING GREEN SURFACE

The Shire of Dalwallinu is seeking to engage a suitably qualified and experienced synthetic turf contractor to remove the existing and replace the bowling green surface at the Dalwallinu Bowling Greens.

All requests for tender documentation can be directed to Deb Whitehead via email ea@dalwallinu.wa.gov.au.

All tenders must be received prior to the tender deadline, contained in a sealed envelope, clearly marked with the tender number and tender name and lodged in the tender box situated in the office of Shire of Dalwallinu, 58 Johnston Street, Dalwallinu WA 6609, by post to PO Box 141 Dalwallinu 6609 or emailed to tenders@dalwallinu.wa.gov.au.

Tenders close at 2pm, Wednesday 21 January 2026.

Jean Knight JP
Chief Executive Officer

Place of wheat and wattle....

Works & Services



The Shire has undertaken kerbing works on Locke Street, Kalannie



Reconstruction and culvert works have begun on Dowerin-Kalannie Road. The Shire installed the culverts and Fulcher Contractors are the contractors completing the road works.

Place of wheat and wattle....

Youth Advisory Council



Hey Dalwallinu Youth – We Want Your Ideas!
Youth Lounge • Skate Park • School Holidays

What activities do you want to see in town?

Got cool new ideas or ways to make our hangout spots
even better? We're all ears!

Swing by the **DDC** today to grab a copy of the
Shire of Dalwallinu survey and let us know what would
make Dalwallinu more fun for you and your friends.

Your ideas can help shape a town that's
awesome for everyone!



Youth Advisory Survey



Youth Lounge, Skate Park, School Holidays

Tell us what activities you'd love to see in our town, whether they're new ideas or maybe improvements to existing spaces!

Your ideas will help shape a more fun and exciting place for everyone to enjoy.

1. How often do you use the Youth Lounge?

- ☐ Daily
- ☐ A few times a week
- ☐ Once a week
- ☐ A few times a month
- ☐ Never – Why Not? (please specify below)

3. What activities do you participate in at the Youth Lounge? (Select all that apply)

- ☐ Playing Games
- ☐ Studying
- ☐ Socialising

4. What do you like the most about the Youth Lounge?

5. What improvements/additions would you like to see in the Youth Lounge?

6. How likely are you to tell you friends about the Youth Lounge?

- ☐ Yes
- ☐ No
- ☐ Maybe

Youth Advisory Survey

7. What fun activities would you like to do in the school holidays

- ☐ Incursion - Workshops in town - Art, Sports, Activities, Movie nights, Disco
- ☐ Excursion - Trips to Bounce, Mini Golf, Aqua, Perth Zoo
- ☐ Other (please specify below)

8. What do you think would be most fun to use - Skate Park or Pump Track (bike track)

- ☐ Skate Park
- ☐ Pump Track
- ☐ Other Ideas (please specify below)

9. What is your age group?

- ☐ Under 12
- ☐ 12-15
- ☐ 16-18

Thank you for taking the time to share your thoughts and ideas, we really appreciate your input.



Place of wheat and wattle....

Accommodation Assistance Required for Students

We are urgently seeking accommodation for next year's student doctors when they visit in March 2026. This initiative has been operating in Western Australia for over 20 years, however the Shire of Dalwallinu have only been involved with this for the last 3 years. We are expecting to host 20 students from 10 to 13 March 2026.

As a host family you are in the unique position of being able to assist and shape the direction that these young people may take. By experiencing life in the country they get a taste of what Rural Doctoring could be. Many of the students taking part in the program have never been outside of Perth.

Shire staff have developed a great relationship with the Supervisors and some of the students have returned to visit and brought their families with them. You may develop lifelong friendships from this experience.

You will need to provide a meal for them on the Tuesday and Wednesday nights and may need to provide them with lunches on some days. The Shire provides a "Thank You" dinner on the Thursday evening which host families are invited to attend. We also extend the invitation to those companies who provide the opportunity for the students to visit during their stay.

If your children are away at school and you have an empty bed for these few days, consider committing to this program. Everyone who has been involved previously has thoroughly enjoyed the experience.

To discuss this further please give Deb a call on 0409 931 407 and she can run through any questions, queries or concerns that you may have.

Share our *Town and rural lifestyle* with doctors of the future

Do you want to help educate our future Doctors?

We will be hosting 20 second-year medical students from Curtin University who will participate in the Curtin Medical School Student Rural Immersion Week in conjunction with the Shire of Dalwallinu, with the aim of inspiring them to pursue careers in rural Western Australia. During their stay, they will visit local farms, industry, general practices, hospitals and schools, and engage in community activities.

Do you live in or near Dalwallinu?

As a host, we will ask you to provide accommodation for one, two or more students for three nights, be able to assist with transporting them to/from town, and share what it is like to live in your town with the students. If you only have the ability to any students please still consider this. If you are interested give Deb a call to discuss this matter further.

Why host?

We would love to hear from you!

This is a life-changing experience for the students, with many having no previous exposure to rural life. By providing these rural immersion opportunities early in their degree, it has been proven that students are more likely to explore rural career opportunities and have a better understanding of treating rural patients. Some students continue to keep in touch and visit their host families, some return to do seasonal work and placements, others have joined mentoring programs and some have inspired host family members to pursue tertiary studies in health and medicine.

For further information, contact Deb Whitehead:

T 0409 931 407

E ea@dalwallinu.wa.gov.au



Place of wheat and wattle....

Employment - Traineeships

WE'RE LOOKING FOR

A TRAINEE

COURSES

- Certificate III in Civil Construction Plant Operations

OR

- Certificate II in Rural Operations

COMMENCING: FEBRUARY 2026

**FOR
FURTHER
INFO
CONTACT**



DEB WHITEHEAD
EA@DALWALLINU.WA.GOV.AU



Public Notices

Department of Transport Licensing Hours

Monday to Friday from 8.30am to 4.00pm

The Shire of Dalwallinu offer licensing facilities on behalf of the Department of Transport. The licensing hours are set by the Department of Transport.

Please ensure you attend the offices early and allow adequate time for processing of your paperwork as the Department of Transport Licensing computers close at 4pm.

Shire staff do not have access after that time to Licensing computers.

If you wish to contact the Department of Licensing their number is **13 11 56** and their website is <https://www.transport.wa.gov.au/licensing/licensing.asp>



SMS Register for Emergency Purposes – Townsites

Do you reside in Buntine, Dalwallinu, Kalannie, Pithara or Wubin? Would you like your mobile number to be added to SMS register for emergency messaging purposes? SMS services could be used for purposes such as evacuation of the area, extreme weather warnings, road closures etc. This register does not include harvest ban information.

To register – please contact Shire Administration 08 9661 0500 or sfo@dalwallinu.wa.gov.au with your name, address and mobile number.

THIS IS NOT THE SAME REGISTER USED FOR HARVEST BANS



Harvest Ban SMS Service

During Harvest time the Shire of Dalwallinu administers the Harvest Ban SMS Service. As soon as a harvest ban is called all mobile phones registered will receive a SMS directly to their mobile phone.

This service is free of any direct charge. Please note that Harvest Bans are called by the Volunteer Fire Control Officers. We urge you to register your details at the Shire. Farmers and business owners, if you have staff who have moved on and you wish to check, or to have them removed from this service please contact Christie.

Fire Rating Widget on Website

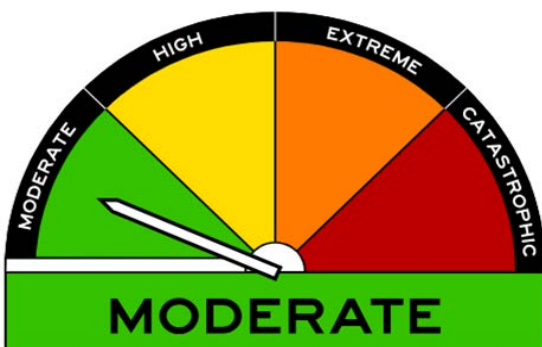

Did you know that the Shire has a Fire Rating widget on the Shire website page?

For current Fire Ratings please check the website. The widget is visible on the top right hand side of the website banner and remains visible no matter what page you are viewing.

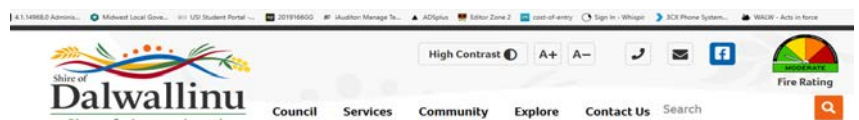

Place of wheat and wattle....

Public Health - Septic Tank Tips

Do's for Maintaining your Septic Tank: The Best Tips

Let's look at all the easy tips you should be doing to avoid costly repairs and keep the overall system working as efficiently as possible.

- Schedule regular maintenance. You should pump out the solid waste in your septic tank every 3-5 years.
- Conserve water. Repair water leaks and use low-flow water-saving devices on every faucet, shower head, and toilet in the house! Monitoring your water usage is one of the best ways to help keep your system running smoothly.
- Protect and inspect the drain field. Have it inspected whenever you have the septic system pumped or cleaned.
- Use septic-approved products. Look for cleaning products and toilet paper that state they are safe for septic systems. You can use septic tank additives if you like, but the truth is that we aren't convinced that they work. They don't cause harm, so you can use them if you like.
- Teach everyone in your household about the septic system. Go over the list of Don't's with everyone in your house to avoid problems.
- Run only full loads when using washing machines or a dishwasher. Water conservation matters!
- Do your laundry over several days, not in one go. Limit yourself to no more than 3 full loads of laundry per day.
- Make sure that your septic tank is the right size for your household. Expand or replace your septic tank with a larger or better design if your family has grown substantially.
- Limit the food scraps that get into the sink. Scrape plates into the garbage first or start a compost bin.



Don'ts for Septic Tank Care: Common Mistakes to Avoid

These are some common mistakes most people make with their septic system.

- Don't flush products not approved for septic tanks. Toilet paper, cigarette butts, feminine hygiene products, disposable diapers, baby wipes, sanitary products, dental floss, paper towels, and other products that are not biodegradable should never be put in your septic system.
- Don't ignore unusual activity. Gurgling drains, slow drains, dirty-looking water in the toilet, bad smells from drains, or soggy soil around the leach drain field are all warning signs that the septic tank is full of solid waste and needs to be pumped.
- Don't pour harsh chemicals, bleaching agents, drain cleaners, or grease down the drain. As you would expect, grease clogs pipes, and harsh chemicals kill the good bacteria that allow your system to work as it should.
- Don't dump even biodegradable items down the drain. While coffee grounds, food scraps, and other biodegradable matters are natural, they tend to be problematic. Use a composting bin or throw them out in the trash.
- Don't plant trees with invasive roots on or around the drain field. If you aren't sure which trees are safe to plant, you can call the friendly staff at Superior Septics.
- Don't use dishwashers or washing machines during heavy rains. Rainfall is already saturating the drain field. Adding extra water from these devices puts a heavy strain on the soil.
- Don't overload your septic tank. Avoid running the dishwasher, washing machine, shower, and toilet simultaneously because this huge amount of water will overburden the irrigation field. Consider running the dishwasher today and the washing machine tomorrow.
- Avoid overusing antibacterial products. Soap is naturally antibacterial so there is no need to use antibacterial soaps. Excessive use of this item can disrupt the natural, friendly bacteria that your septic system thrives on. Look for eco-friendly soaps or go with old-fashioned bar soaps that are environmentally and septic system friendly.



Place of wheat and wattle....

Public Notices



FOR SALE

BUNTINE TOWN HALL



PRICE FROM:
\$ 55,000 (INC
GST)

Offers closing: 2pm, 21 January 2026

Email offer to:
tenders@dalwallinu.wa.gov.au

Place of wheat and wattle....

Available to Loan from the Library for Free

WHAT'S IN A FREE-TO-LOAN HOME ENERGY AUDIT KIT?

Available at your local library



THERMAL IMAGING CAMERA

For locating draughts
around your home,
gaps in insulation
and for checking
fridge seals

PLUG-IN ENERGY MONITOR

For measuring energy
consumption and the
running costs of
appliances



ENERGY EFFICIENCY THERMOMETER

For measuring
the temperature
of rooms, fridges
and freezers

BASIN FLOW MEASURING CUP

To measure water
flow from tapware

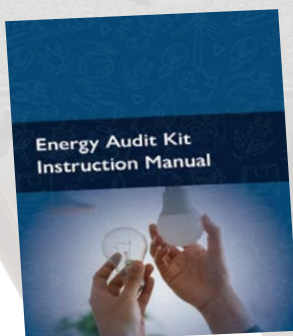

36 PAGE INSTRUCTION MANUAL

With 5 energy audit
tests and 3 water
audit tests, quick
tips, and information
on how to develop
your action plan

**PLUS
OTHER
USEFUL
RESOURCES!**

For more information including
energy audit kit locations and to
watch an instructional video, visit

switchyourthinking.com/energy



Department of
Energy and Economic
Diversification



Place of wheat and wattle....

Public Notices

**OFFERS FROM \$143,000
(INC GST)**



FOR SALE

This building was constructed with bricks and concrete with a tin roof - circa 1960.

The land will require re-zoning from 'Reserve' to 'Townsite'



PROPERTY FEATURES

- ✓ Wubin Town Hall
- ✓ Supper Room
- ✓ Two blocks (2,024m²)
- ✓ External toilets
- ✓ Renovators delight

CONTACT US NOW

ceo@dalwallinu.wa.gov.au

Place of wheat and wattle....

Industrial Land for Sale



3
LOTS
LEFT

- Fully serviced lots*
- Titles anticipated July 2025
- To continue the development of a vibrant rural community, purchasers are required to build within 36 months from settlement.

*No reticulated sewer – owner to install attenuation system.

Nutrien Harcourts WA
Brad King 0429 911 504
brad.king@nutrien.com.au

developmentwa.com.au/dalwallinu

LAND FOR SALE

LOT	ADDRESS	LOT AREA SQM	PRICE EX GST
821	York Street	10,019sqm	\$318,181
822	York Street	10,103sqm	\$318,181
823	York Street	11,763sqm	\$372,727
829	Butcher Place	5,965sqm	Under Offer
830	Butcher Place	5,432sqm	Under Offer
835	York Street	5,844sqm	Under Offer
836	York Street	5,433sqm	Under Offer
842	York Street	4,684sqm	Under Offer

RDAP helps Local Governments to address the high costs associated with residential, industrial and commercial land developments in regional WA. Through these partnerships, DevelopmentWA, on behalf of the State Government, is helping to deliver the land needed to support regional growth and to build great communities.

Disclaimer: The information contained in this publication is in good faith; however neither DevelopmentWA nor any of its directors, agents or employees give any warranty of accuracy nor accepts any liability as a result of a reliance upon the information, advice, statements or opinion contained in this publication. This disclaimer is subject to any contrary legislative provisions. © DevelopmentWA 2025 RDAP 0008 07/25.

Industrial Lands Authority

Shaping our State's future



Place of wheat and wattle....

Residential Land for Sale

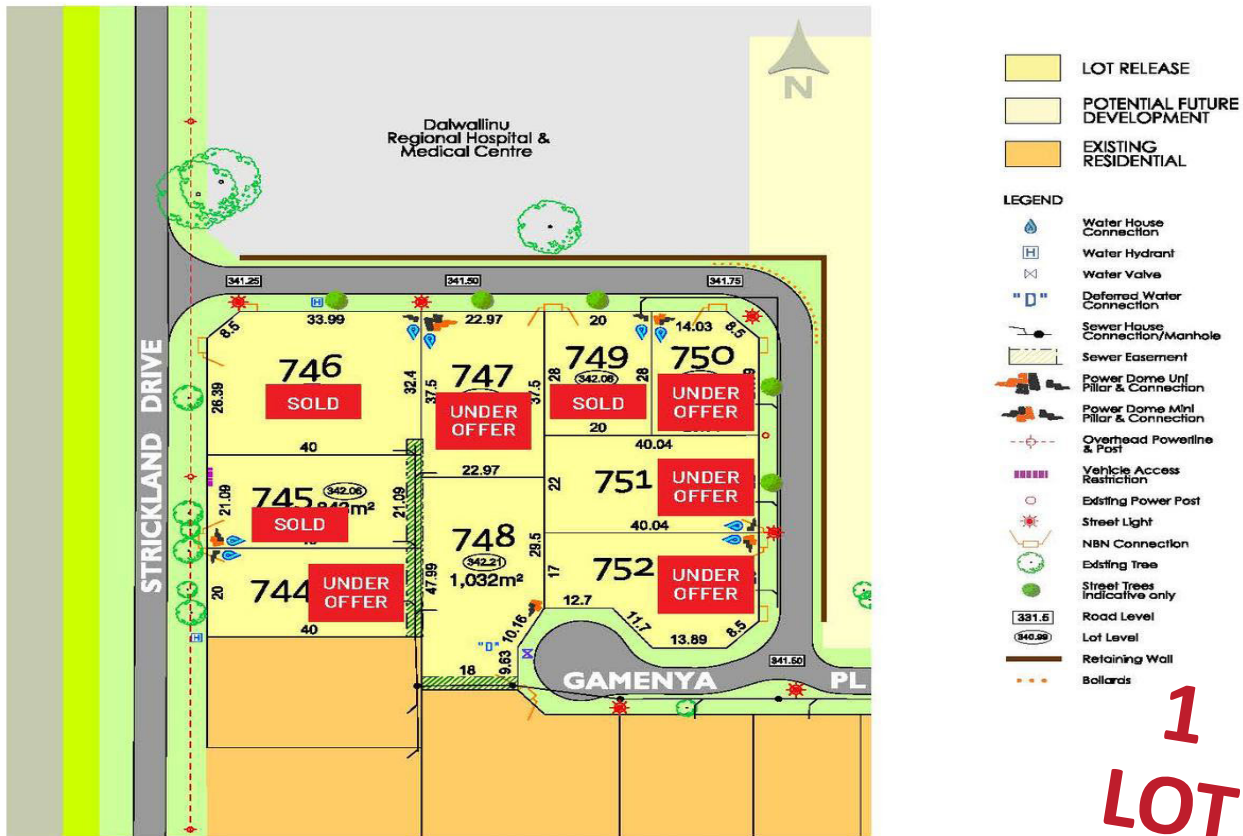

- Lot sizes range from 543sqm to 1,277sqm
- Fully serviced lots with power, water, sewer, and NBN conduit supplied to each lot boundary
- Lots titled and ready for development
- To continue the development of a vibrant rural community, purchasers are required to build within 36 months from settlement.

LAND FOR SALE

LOT	ADDRESS	LOT AREA SQM	PRICE INC GST
744	Strickland Drive	800sqm	Under Offer
745	Strickland Drive	842sqm	Under Offer
747	Magenta Mews	861sqm	Under Offer
748	Gamenya Place	1,031sqm	\$139,000
750	Magenta Mews	542sqm	Under Offer
751	Magenta Mews	880sqm	Under Offer
752	Gamenya Place	875sqm	Under Offer

Nutrien Harcourts WA - Brad King 0429 911 504
brad.king@nutrien.com.au

developmentwa.com.au/dalwallinu

All dimensions and areas are preliminary and subject to survey. The particulars on this brochure are supplied for identification purposes only and shall not be taken as a representation in any respect on the part of the vendor or its agents. Authorities should be consulted when services are contained within lot boundaries as building restrictions may apply.

Disclaimer: The information contained in this document is in good faith; however, neither DevelopmentWA nor any of its directors, agents or employees give any warranty of accuracy nor accepts any liability as a result of a reliance upon the information, advice, statement or opinion contained in this document. This disclaimer is subject to any contrary legislative provisions. © DevelopmentWA 2025. RDAP 0005 - 10/25.

Shaping our State's future



Place of wheat and wattle....

2026 Council Meeting Dates



DATE	DAY	TIME	PLACE
24 February 2026	Tuesday	5.00pm	Council Chambers
24 March 2026	Tuesday	5.00pm	Council Chambers
28 April 2026	Tuesday	5.00pm	Kalannie Sport & Recreation Club
26 May 2026	Tuesday	5.00pm	Council Chambers
23 June 2026	Tuesday	5.00pm	Council Chambers
28 July 2026	Tuesday	5.00pm	Council Chambers
25 August 2026	Tuesday	5.00pm	Council Chambers
22 September 2026	Tuesday	5.00pm	Council Chambers
27 October 2026	Tuesday	5.00pm	Council Chambers
24 November 2026	Tuesday	5.00pm	Council Chambers
15 December 2026	Tuesday	5.00pm	Council Chambers

Jean Knight JP
Chief Executive Officer
25/11/2025

Place of wheat and wattle....

2025-2026 Recycle Calendar Dates



July 2025						
S	M	T	W	T	F	S
		1	2	3	4	5
6	7	8	9	10	11	12
13	14	15	16	17	18	19
20	21	22	23	24	25	26
27	28	29	30	31		

August 2025						
S	M	T	W	T	F	S
					1	2
3	4	5	6	7	8	9
10	11	12	13	14	15	16
17	18	19	20	21	22	23
24	25	26	27	28	29	30
31						

September 2025						
S	M	T	W	T	F	S
	1	2	3	4	5	6
7	8	9	10	11	12	13
14	15	16	17	18	19	20
21	22	23	24	25	26	27
28	29	30				

October 2025						
S	M	T	W	T	F	S
			1	2	3	4
5	6	7	8	9	10	11
12	13	14	15	16	17	18
19	20	21	22	23	24	25
26	27	28	29	30	31	

November 2025						
S	M	T	W	T	F	S
						1
2	3	4	5	6	7	8
9	10	11	12	13	14	15
16	17	18	19	20	21	22
23	24	25	26	27	28	29
30						

December 2025						
S	M	T	W	T	F	S
	1	2	3	4	5	6
7	8	9	10	11	12	13
14	15	16	17	18	19	20
21	22	23	24	25	26	27
28	29	30	31			

January 2026						
S	M	T	W	T	F	S
				1	2	3
4	5	6	7	8	9	10
11	12	13	14	15	16	17
18	19	20	21	22	23	24
25	26	27	28	29	30	31

February 2026						
S	M	T	W	T	F	S
1	2	3	4	5	6	7
8	9	10	11	12	13	14
15	16	17	18	19	20	21
22	23	24	25	26	27	28

March 2026						
S	M	T	W	T	F	S
1	2	3	4	5	6	7
8	9	10	11	12	13	14
15	16	17	18	19	20	21
22	23	24	25	26	27	28
29	30	31				

April 2026						
S	M	T	W	T	F	S
			1	2	3	4
5	6	7	8	9	10	11
12	13	14	15	16	17	18
19	20	21	22	23	24	25
26	27	28	29	30		

May 2026						
S	M	T	W	T	F	S
					1	2
3	4	5	6	7	8	9
10	11	12	13	14	15	16
17	18	19	20	21	22	23
24	25	26	27	28	29	30
31						

June 2026						
S	M	T	W	T	F	S
	1	2	3	4	5	6
7	8	9	10	11	12	13
14	15	16	17	18	19	20
21	22	23	24	25	26	27
28	29	30				

Recycle Days

-  Kalannie
-  Dalwallinu & Pithara
-  Christmas Day



WHAT CAN GO INTO YOUR RECYCLE BIN

- **Glass** - All glass and ceramics, whole and broken
- **Plastic** - All plastic containers and plastic wraps (empty with lids off)
- **Paper** - All paper, junk mail and glossy magazines
- **Cardboard** - All cardboard products
- **Aluminium & Steel** - All metals, steel & aluminium excluding aerosol cans
- **Liquid Paperboard** - Milk, juice and laundry detergent cartons.

There will be changes to the service over the Christmas Period, will advise closer to date.

Next Ordinary Meeting of Council - 5.00pm Tuesday 16 December 2025

Dalwallinu Council Chambers, 58 Johnston Street, Dalwallinu WA 6609

MEMBERS OF THE PUBLIC ARE WELCOME TO ATTEND

The public are invited to attend any Ordinary Council Meeting to ask questions of the Shire & Councillors. Ordinary Council Meetings are held on the fourth Tuesday of every month (except January) commencing at 5.00pm unless advertised otherwise.

ELECTED MEMBERS OF SHIRE OF DALWALLINU COUNCIL



Cr Steven Carter
0428 663 017
crscarter@dalwallinu.wa.gov.au



Deputy Shire President
Cr Melissa Harms
0437 663 035
crmharms@dalwallinu.wa.gov.au



Cr Jemma Counsel
0428 642 085
crjcounsel@dalwallinu.wa.gov.au



Shire President
Cr Keith Carter
0428 643 051
crkcarter@dalwallinu.wa.gov.au



Cr Shannon Dawson
0429 922 592
crsdawson@dalwallinu.wa.gov.au



Cr Shane Hickleton
0421 201 256
crshickleton@dalwallinu.wa.gov.au



Cr Diane Cream
0417 908 317
crdcream@dalwallinu.wa.gov.au

YOUR EMAILS WANTED

The Shire of Dalwallinu like to regularly share relevant information with the community. Follow us on facebook (Shire of Dalwallinu), visit our website (www.dalwallinu.wa.gov.au) or phone us 08 9661 0500 if you require any assistance.

If you wish to receive this newsletter electronically use the Contact Us tab on our website or email ea@dalwallinu.wa.gov.au